

# INSTALLATION INSTRUCTIONS

EVO PLUS 70 COMFORT BACK TO WALL TOILET SUITE

EVB70N

progetto  
DESIGN COLLECTION

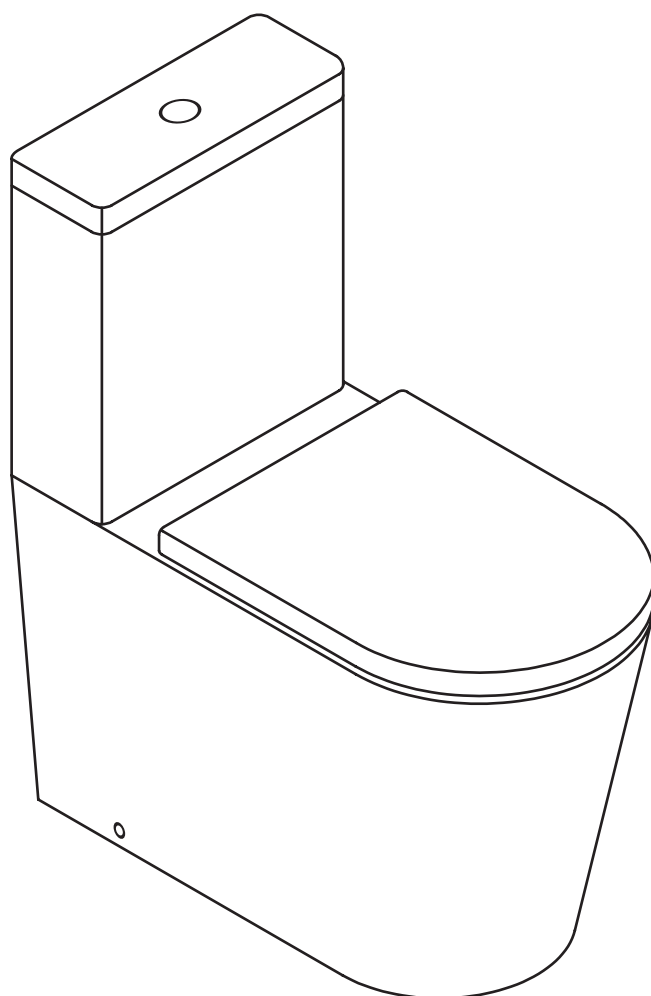

**IMPORTANT!**

Please read these instructions **prior** to installation

Distributed by:

**Plumblin**e

T 04 568 9898 E [sales@plumblin.co.nz](mailto:sales@plumblin.co.nz)  
[www.plumblin.co.nz](http://www.plumblin.co.nz)

## Care & Conditions Of Use

Clean your toilet with a damp cloth and a non-abrasive liquid cleaner. Stubborn stains and scratches can be removed with a light application of Brasso or a similar cutting compound. Avoid abrasive cleaners, solvents, heat and sharp objects. The use of cleaners incorporating ingredients which have been identified as having harmful effects on ceramic glazing will void the warranty.

## General Installation Instructions

Please carefully check the toilet and cistern prior to installation to ensure it has not been damaged during handling or transport, and check that all parts have been supplied.

Installation should be carried out by a qualified, licensed tradesperson.

In the unlikely event of product failure, please refer to the Warranty Information on the back page.

In new buildings it is recommended to fill the traps with water to ensure toxic gases do not corrode the surface of the taps and toilet seats fittings.

Fix all the outlet and inlet valves before installation.

Periodic cleaning and maintenance should be used to avoid formation of damaging lime scale deposits.

Astringent cleaning agents may damage some materials, such as seat hinges and plastic components.

## Tools Required For Installation

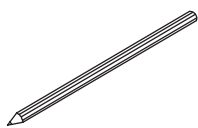

Pencil

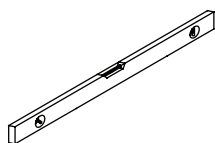

Level

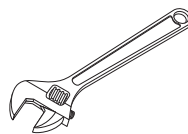

Adjustable Wrench

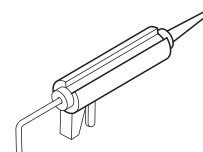

Caulking Gun/Silicone

## Specification Drawing

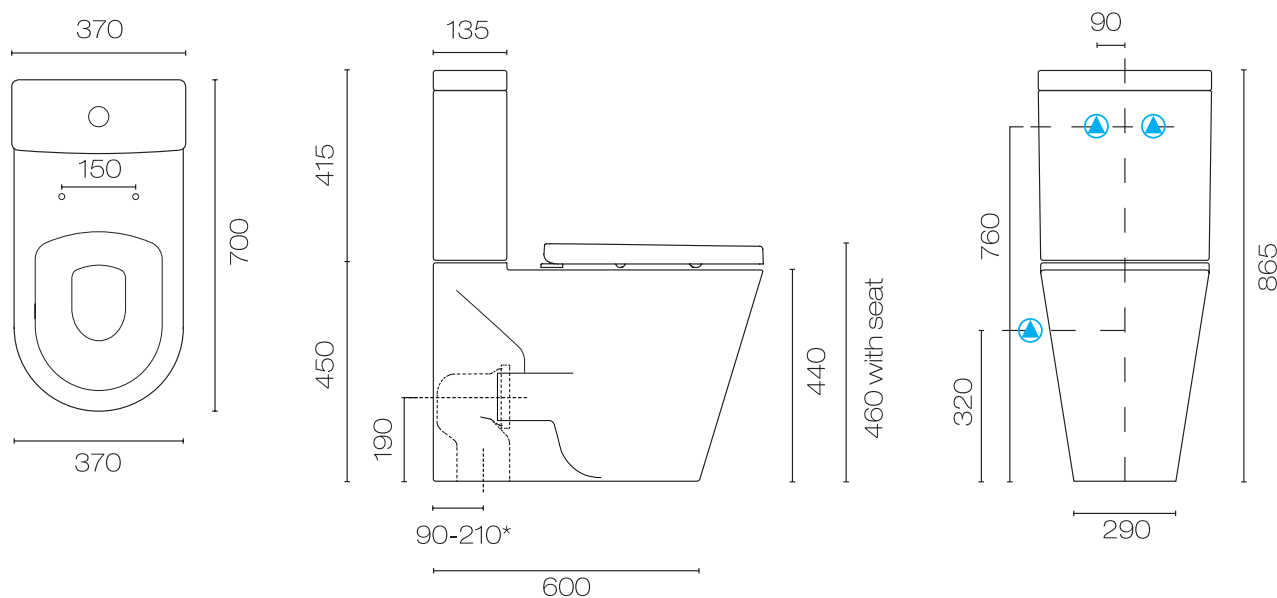

(\*PCOF100 connector - 250mm MAX)

▲ WATER ENTRY

1. Prepare the water inlet, waste pipe and fixing brackets as per the dimensions illustrated at right and the Specification Drawing.

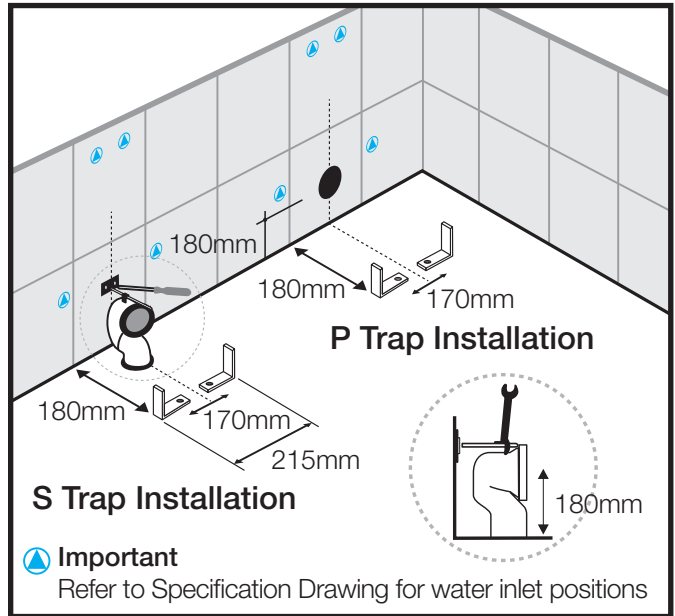

2. Install the flushing mechanism in the cistern. If you are using the rear water inlet option then connect the flexible hose to the connection on the wall.

Place the WC on the floor brackets and push it back against the wall, taking care of the waste pipe connection which must be perfectly aligned to each other. To make the connection easier apply some lubricant (e.g. liquid soap) to both sides.

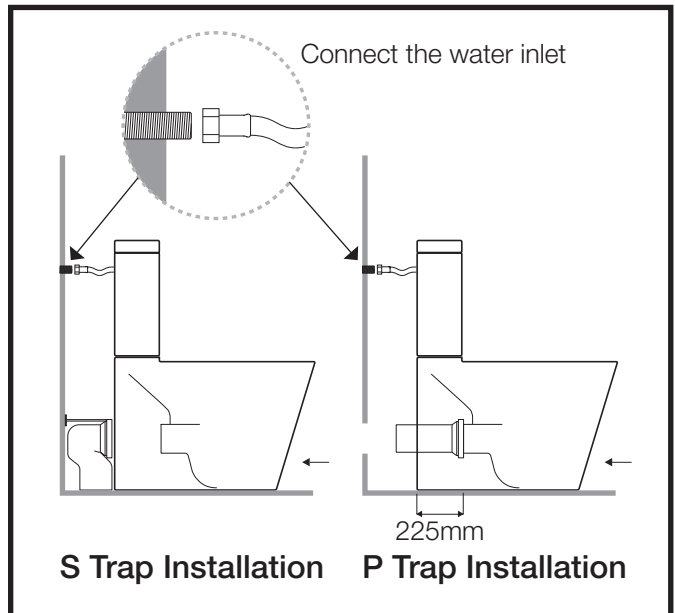

3. Check that the toilet is level and if necessary put some packers underneath the toilet pan to level it up.

Align the toilet and secure it to the floor using the screws supplied. It is recommended to tighten the screws alternatively to secure an equal fit against the wall.

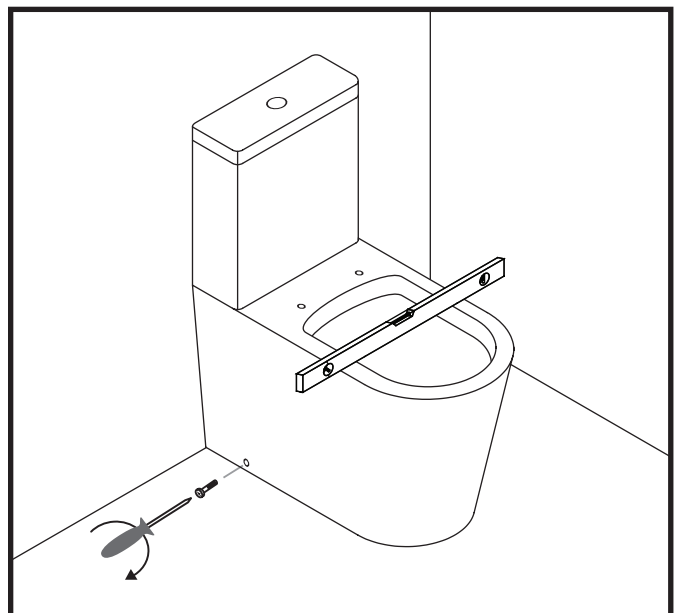

4. If you are using the bottom water inlet option then connect the flexible hose to your stop tap.

Make a final check for any water leaks, then apply a bead of silicone between the pan and adjacent surfaces.

Install the toilet seat as per the supplied toilet seat instructions.

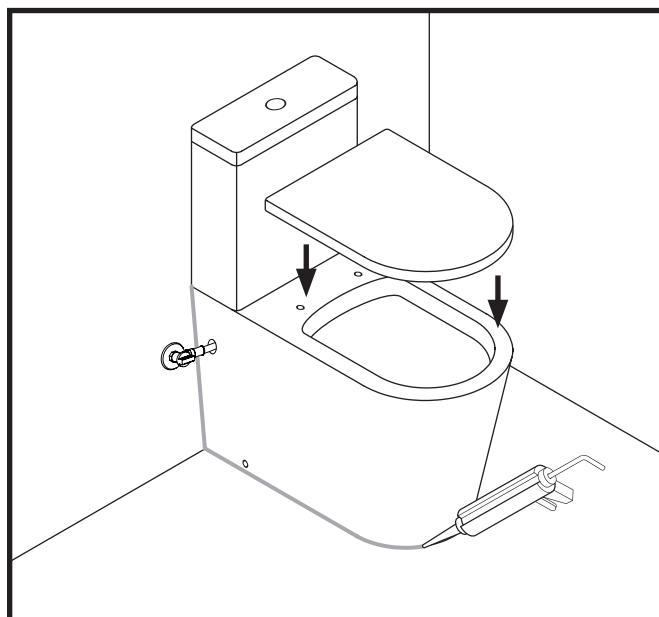

## Warranty Information

Five (5) Year warranty from date of purchase. Due to manufacturer's conditions, toilet cistern mechanisms, fittings, working parts and toilet seats carry a One (1) Year warranty from date of purchase.

Plumblinc will undertake to replace free of charge any faulty product due to defects in materials or manufacturer workmanship within the warranty period (Proof of purchase must be retained). Plumblinc will also supply parts and labour costs for the replacement or repair of any faulty product within One (1) Year of installation date.

Plumblinc (or their approved retailer) reserve the right to assess, repair, replace or service any warranty claims as they see fit.

The above warranties are upheld providing the products have been used for normal domestic only and exclude any defect or injury caused by or resulting from misuse, abuse or neglect, accidental damage, improper installation or other alterations or modifications which affect the reliability or performance of the item not attributed to faulty manufacture. The above warranties do not apply to the replacement of products where damage is caused by normal wear and tear, where the hot water temperature exceeds 55°C or where the warranty claim has not been notified to Plumblinc (or their approved retailer) within ninety (90) days of the problem first appearing.

The above warranties do not include consequential loss or damage due to the product.